

1-2

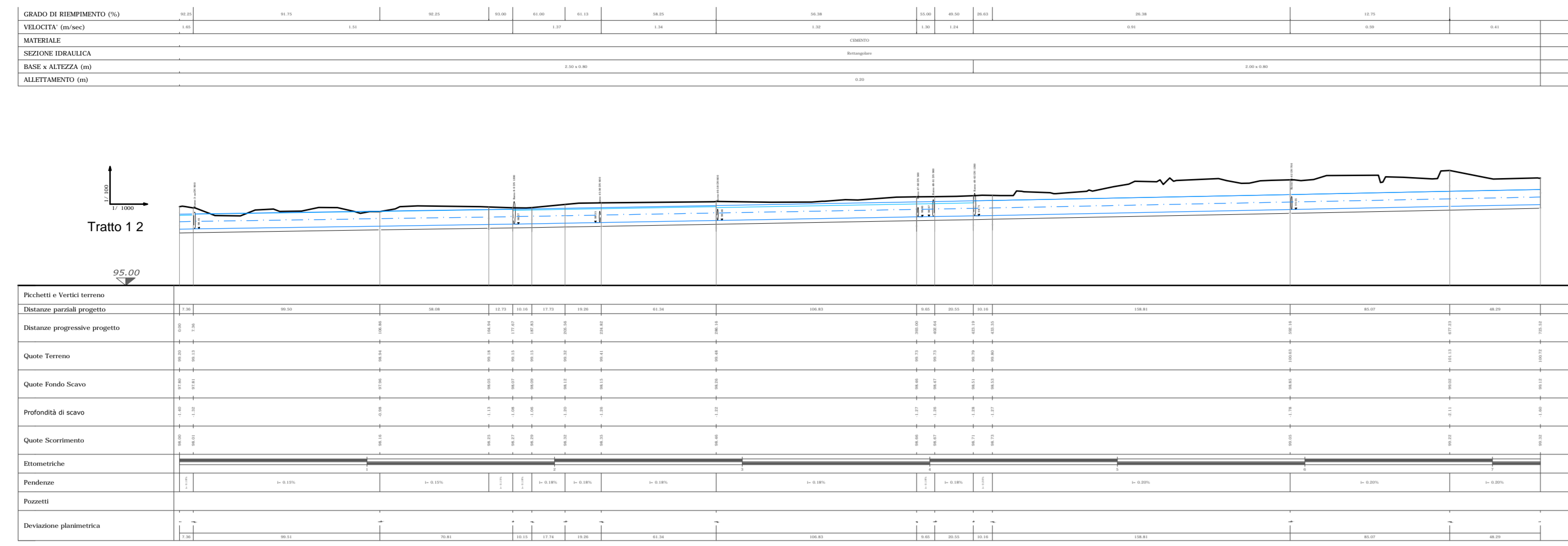

8-9

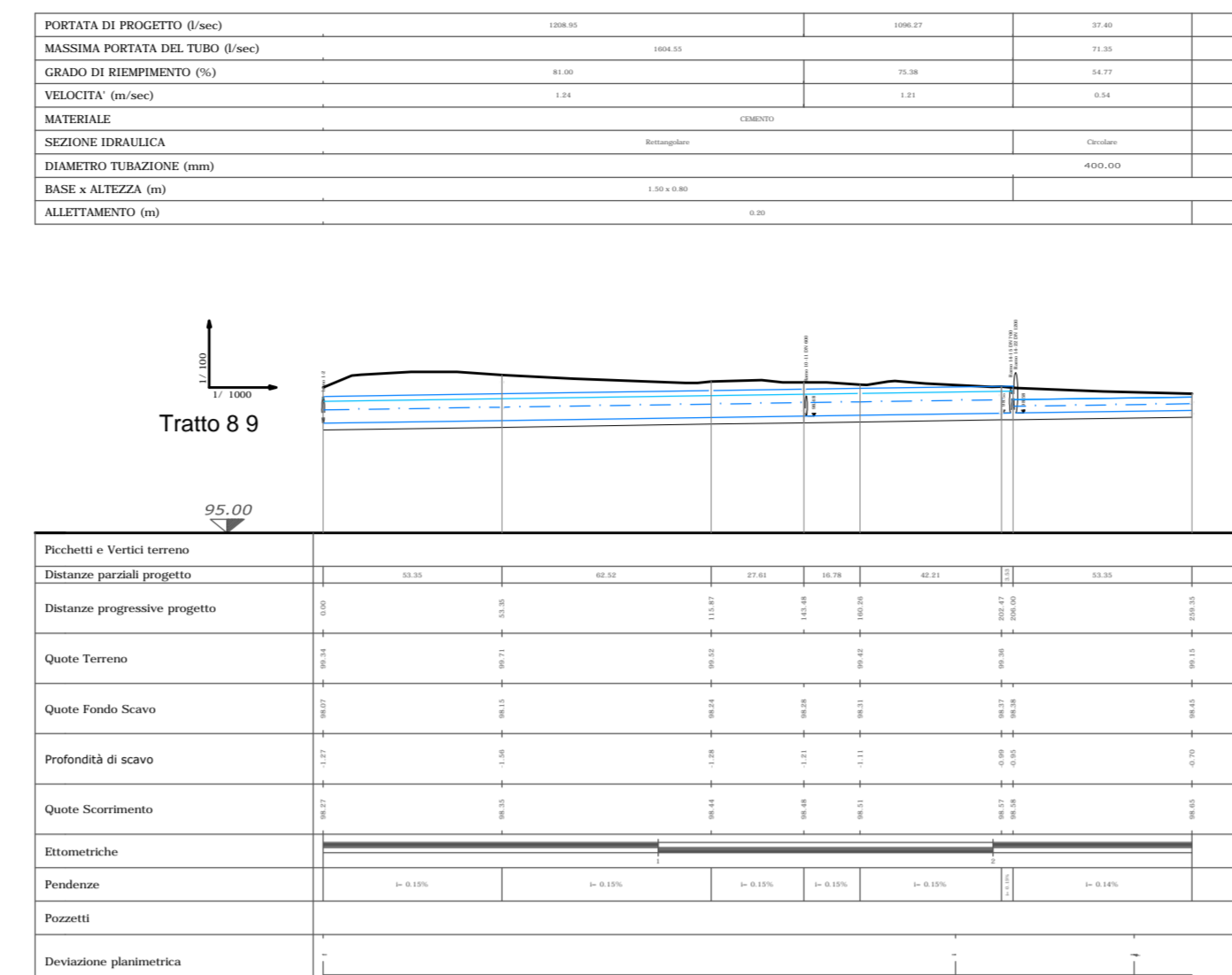

14-22

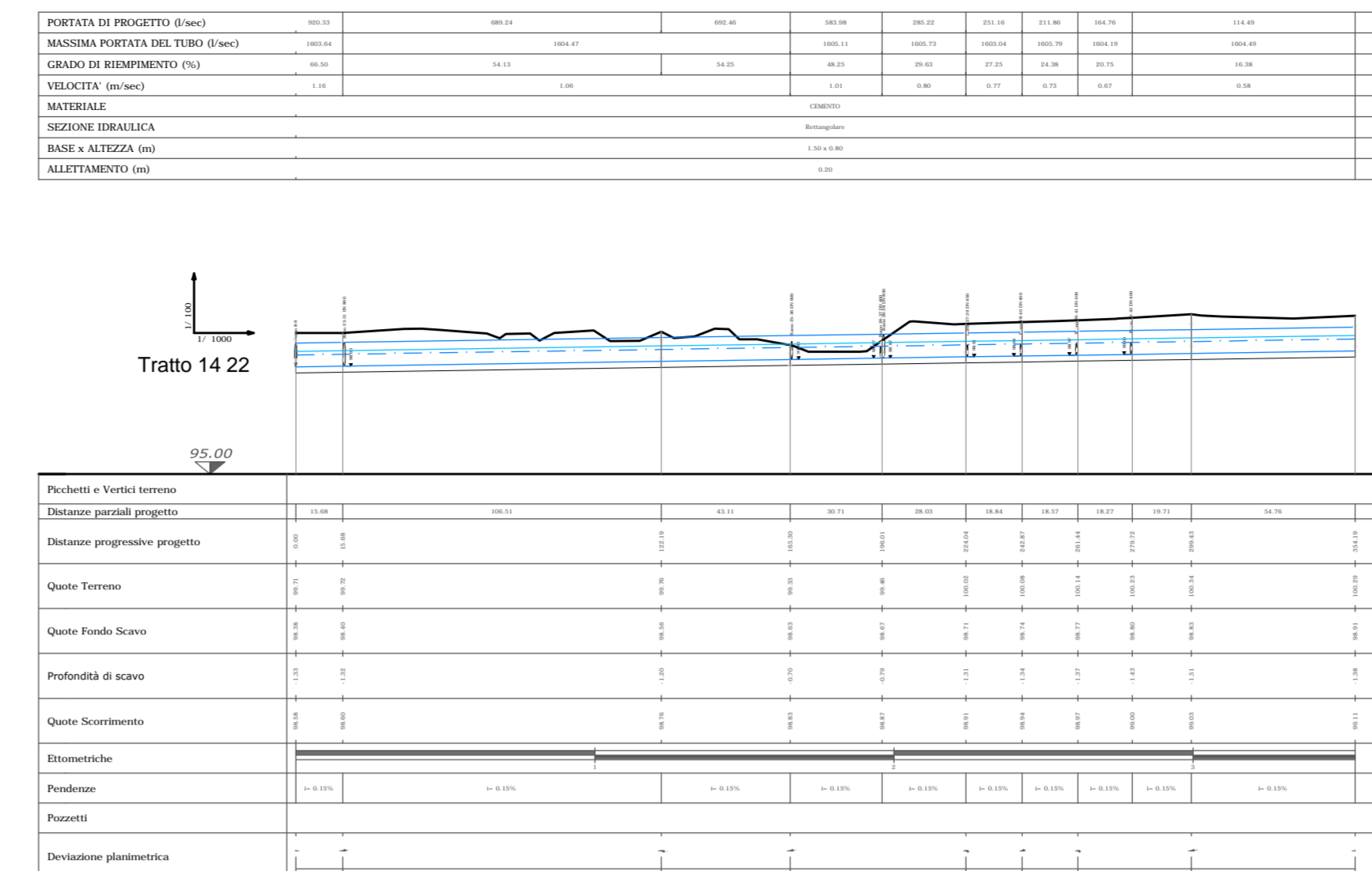

49-63

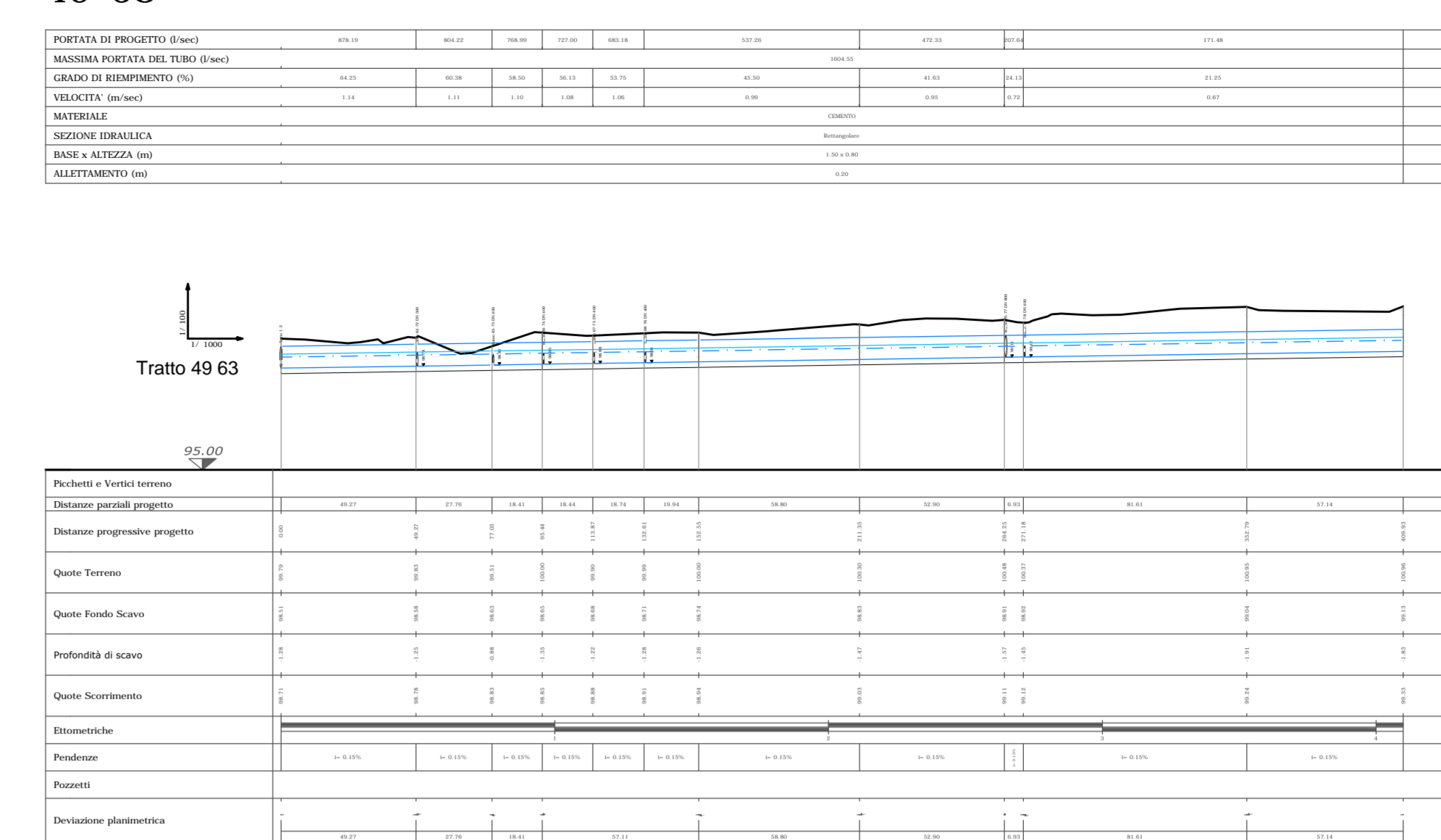

26-38

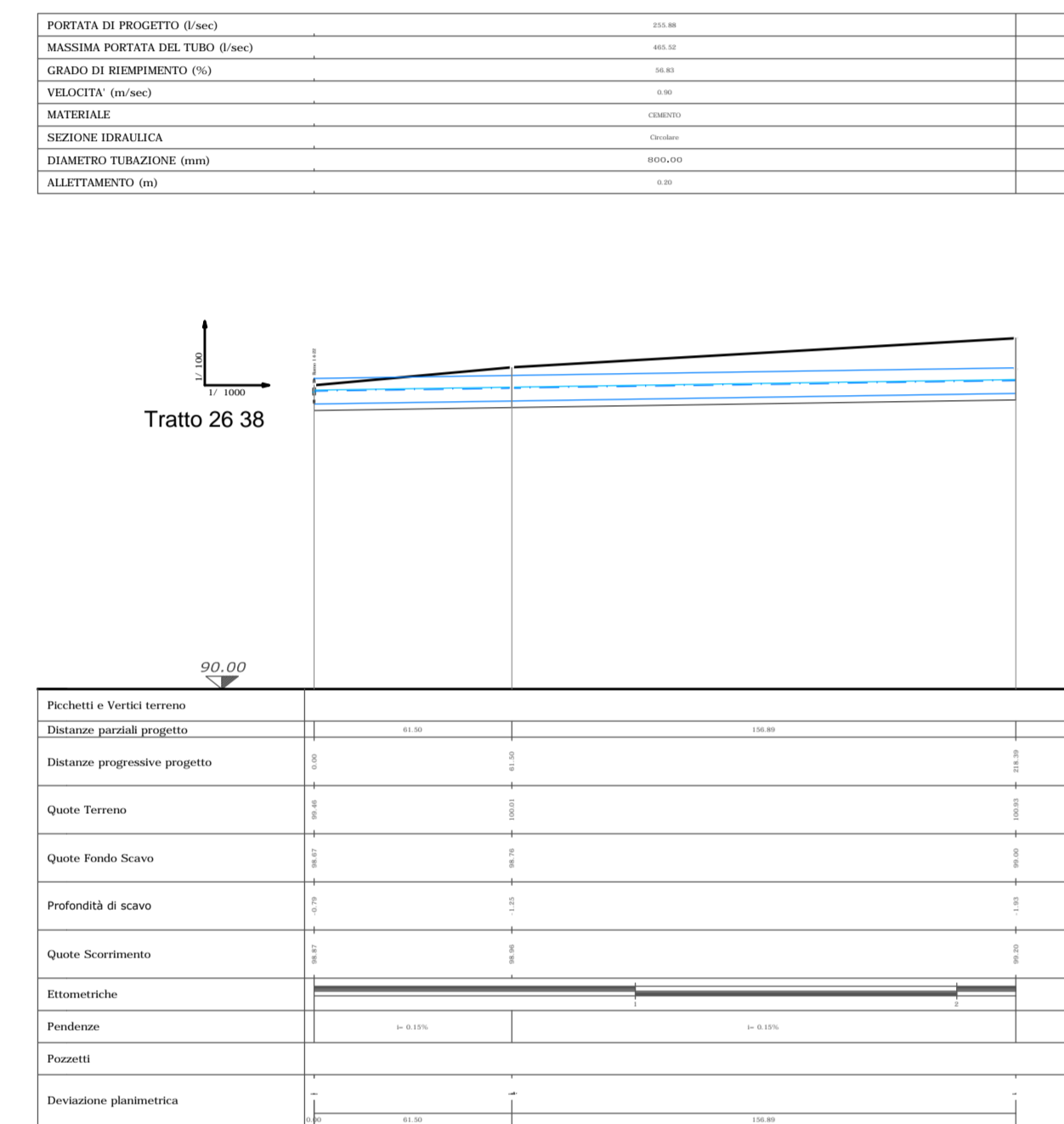

3-AA

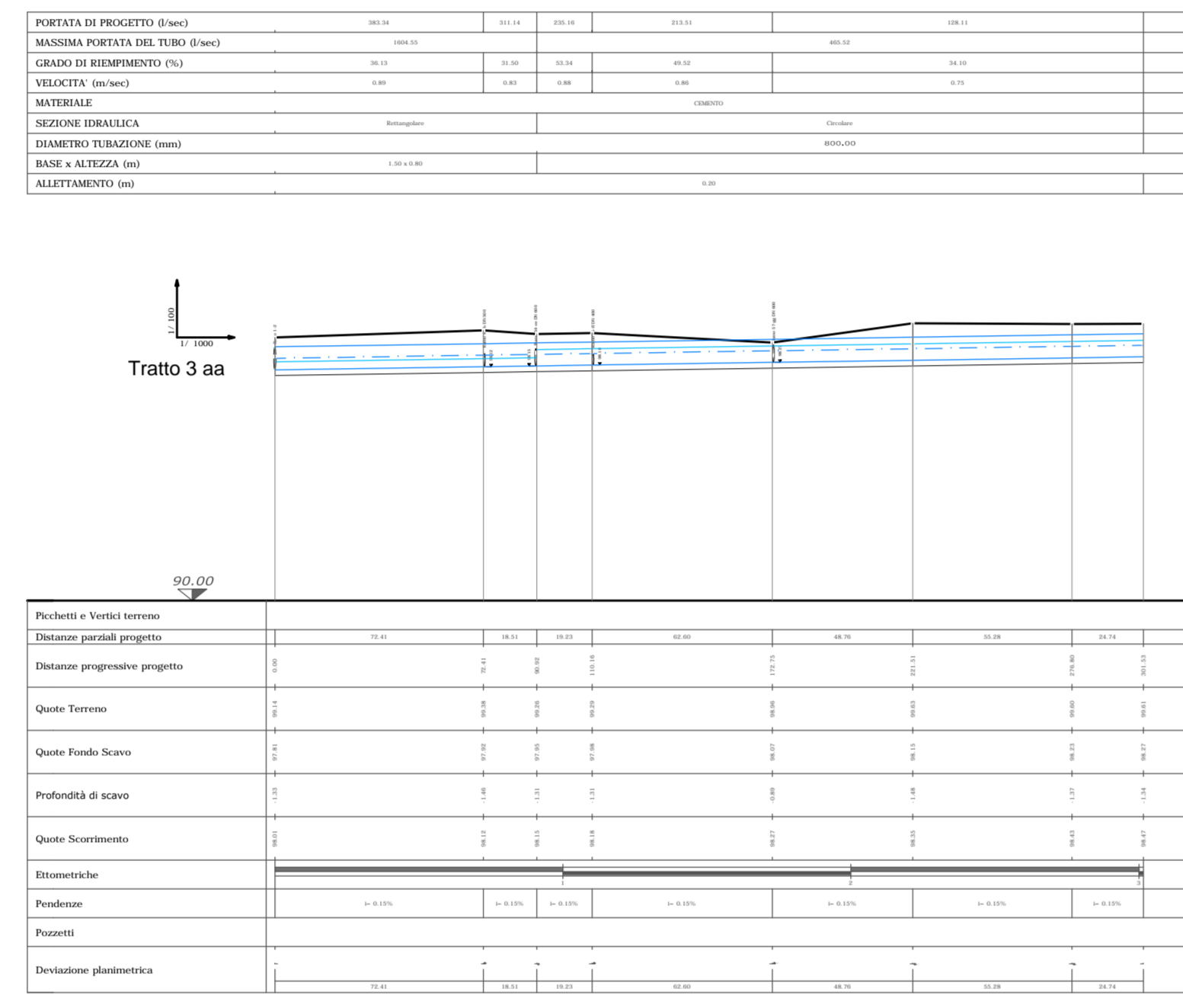

23-31

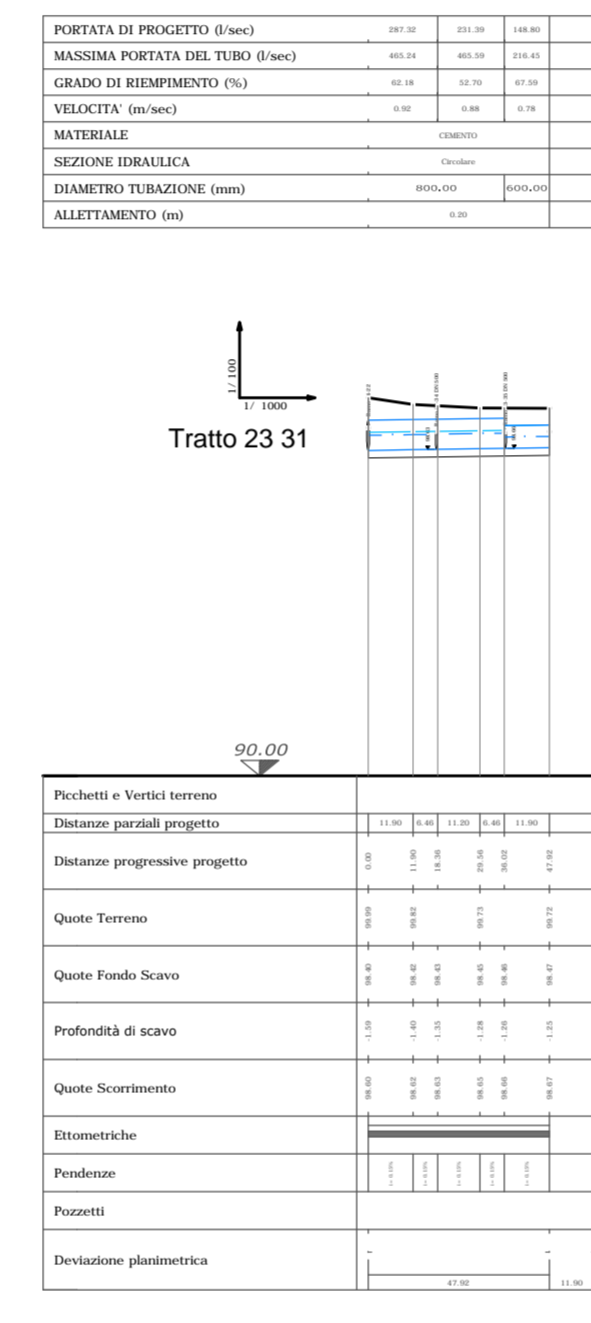

47-60

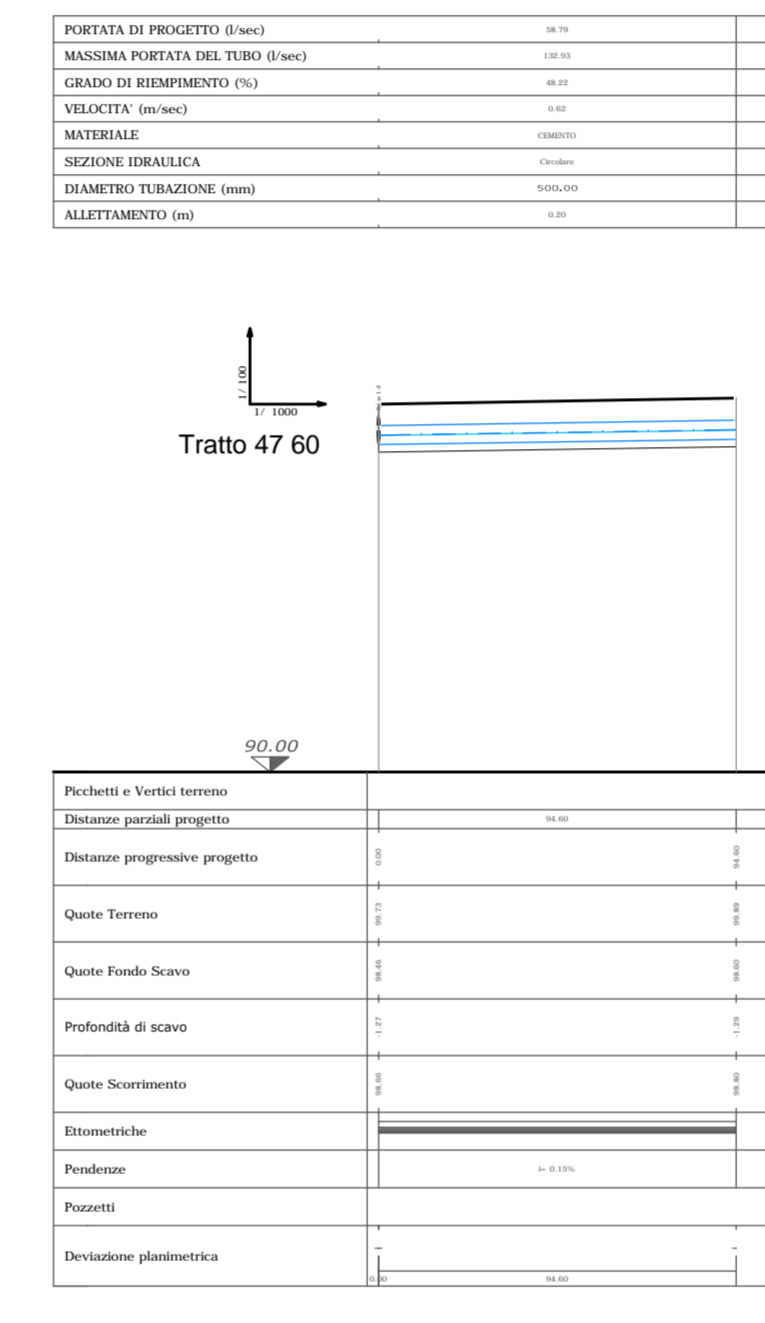

25-36

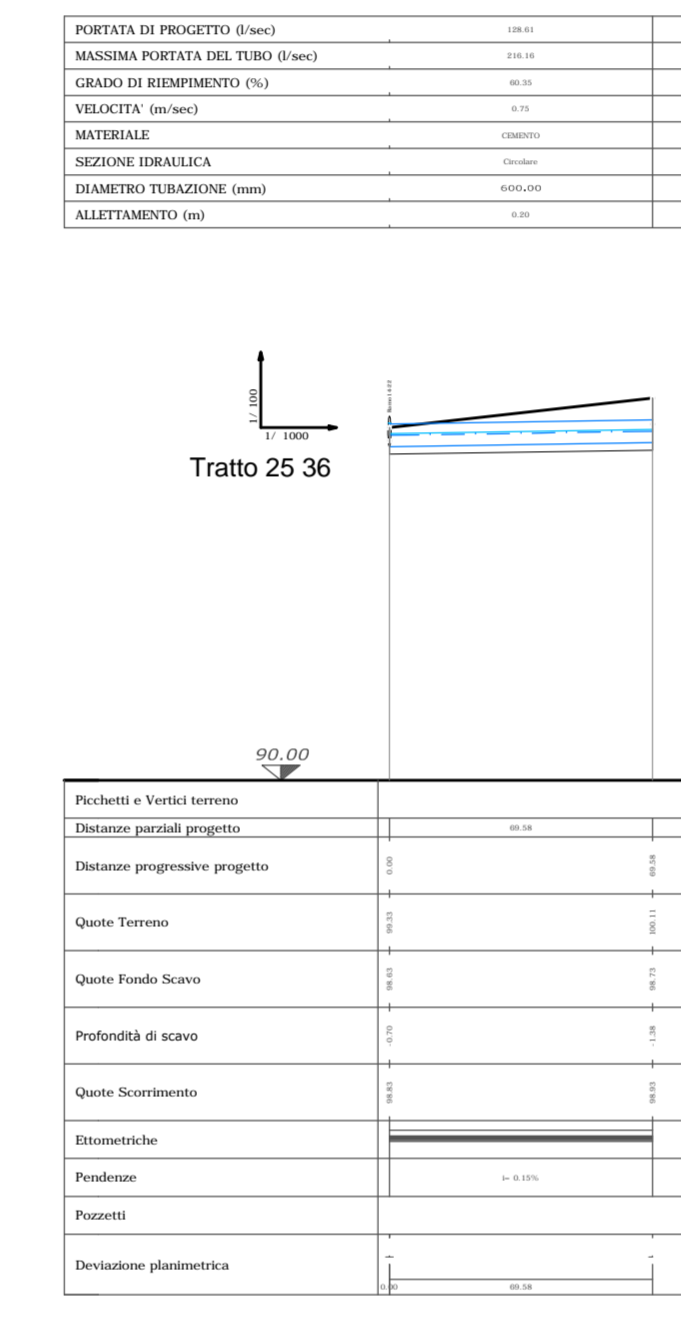

101-102

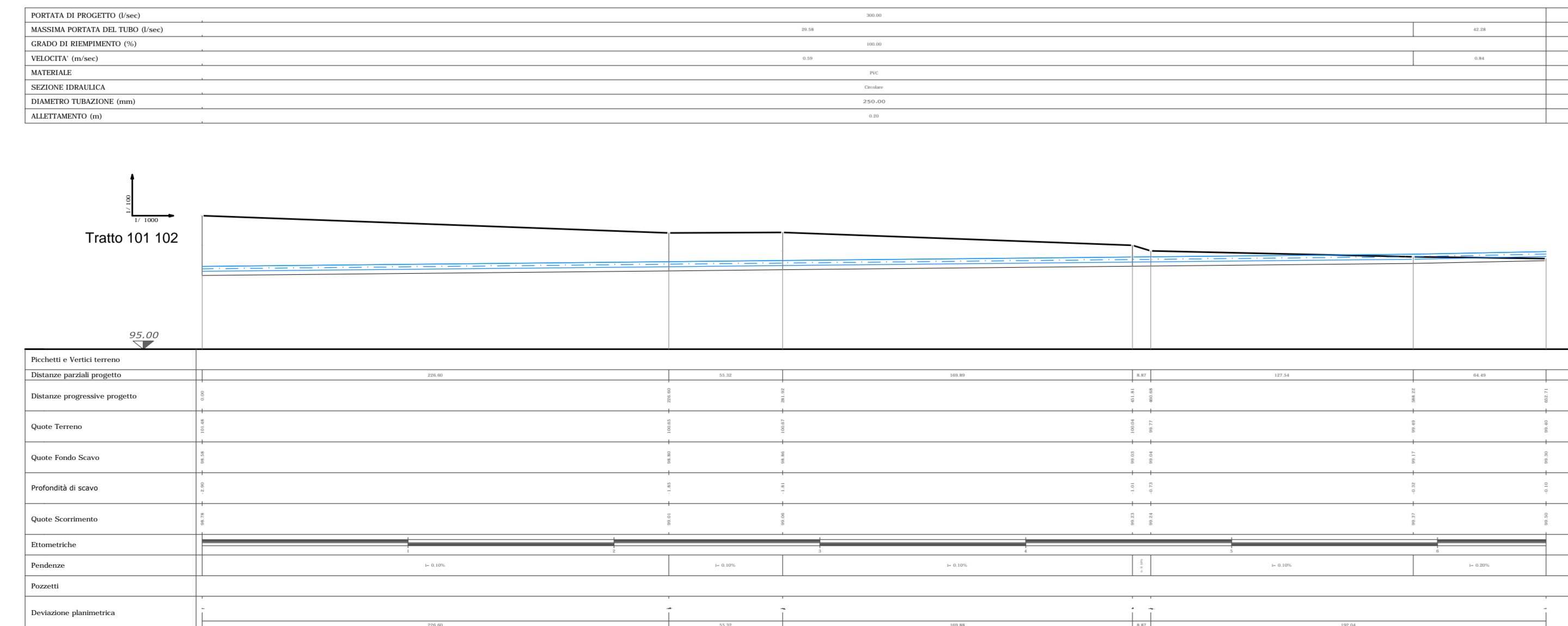

103-104

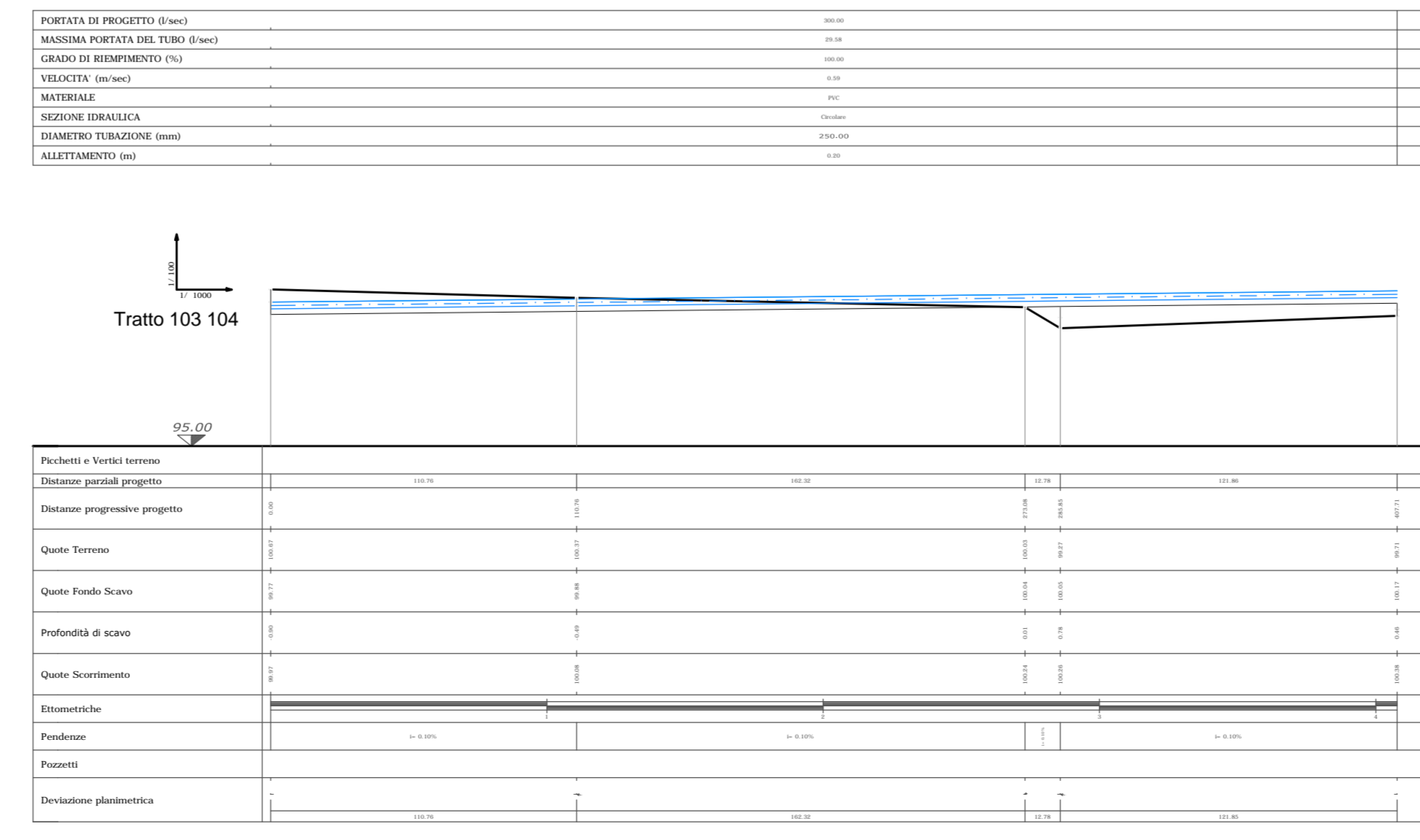

105-106

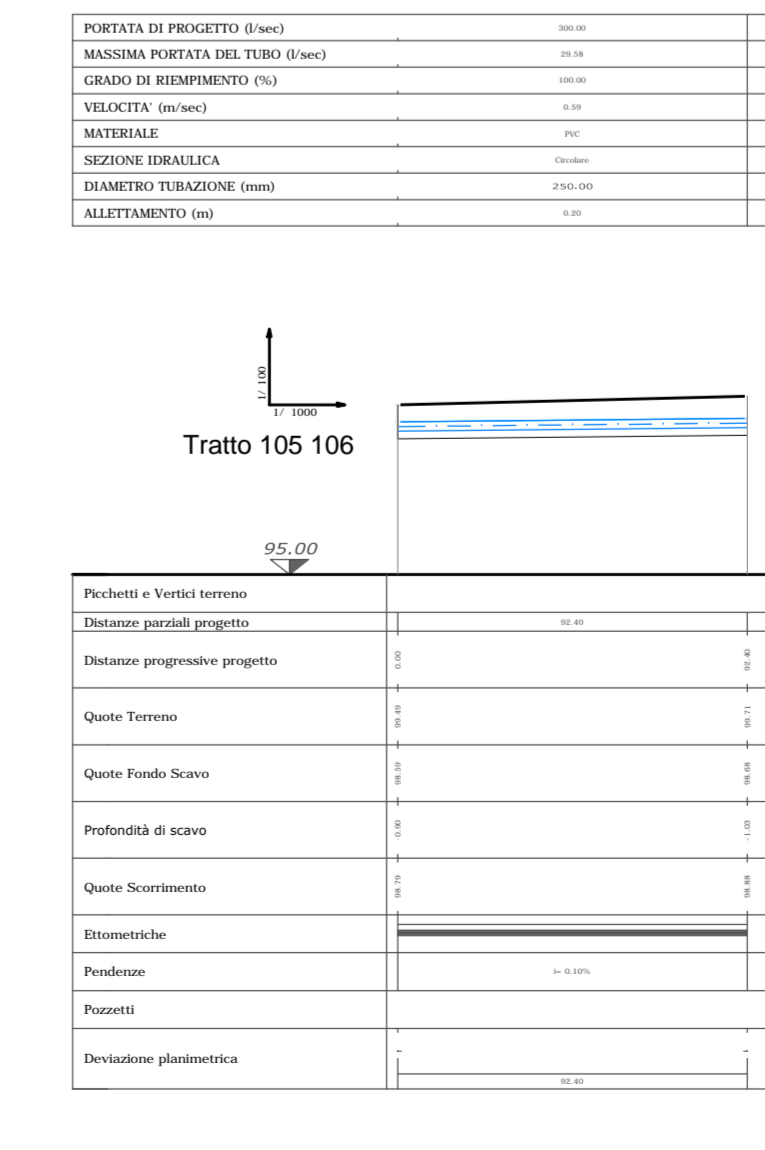

progettazione urbanistica  
arch. Luigi Benatti

progettazione impianti meccanici  
ing. Massimo Savini

progettazione impianti elettrici  
ing. Federico Gasperini

progettazione impianti idraulici  
ing. Stefano Melotti

Acustica  
ing. Gildo Tomassetti

COMUNE DI IMOLA



Piano Urbanistico Attuativo  
di iniziativa privata  
Comparto denominato  
N24A Lasie Selice

PROPRIETA'



GRUPPO BASSO S.P.A.  
via Fellina n. 256 - 41100 TREVISO  
Cod. Fisc. 02477650275  
Part. IVA 02275800262

Profili infrastrutture  
a rete: fognature e  
acque bianche

U10b

data di emissione: 24-07-2019  
disegnato da: CF  
approvato da: LB

TECO+ Partners

studio tecnico associato con sede in via Titania 202/b - 40128 Bologna - tel./fax: 051/264281 / 051/379161 - e-mail: teco@tecoassociati.it